



CAR ROTISSERIE



INSTRUCTION MANUAL



Read this material before using this product.
Failure to do so can result in serious injury.
SAVE THIS MANUAL.

MANUAL FOR CAR LIFT

This product is designed for repairing and restoring cars and small boats. It can be lifted to 49” and rotate 360°

SAFETY INSTRUCTIONS AND WARNINGS

1. DO NOT exceed the rated capacity.
2. DO NOT stand under the machine when the lift is working.
3. This lift is mainly for lifting; only work under the machine with the support of jack stands. Also make sure the surrounding area is safe.
4. After lifting, only start work after locking the safety lock.

Specification: CAR ROTISSERIE

Maximum Height: 49”

Min Height: 21”

IT IS RECOMMENDED THAT BEFORE BEGINNING THE ASSEMBLY PROCESS, YOU LAY OUT EVERYTHING IN AN OPEN AND CLEAN AREA. SEPARATE INTO GROUPS ALL NUTS, BOLTS, ARMS AND ANY OTHER PIECES.

STEP 1. START BY BOLTING ARM (#41) TO MAIN STAND (#34) DO THIS TO BOTH ENDS USING SUPPLIED HARDWARE NOTATED ON THE BREAKDOWN BELOW.



STEP 2. ATTACH CASTERS. YOU'LL USE THE LARGE CASTERS #37 ON THE OUTSIDE LEGS AND SMALLER DIAMETER CASTERS #42 ON THE CENTER LEGS #41

(#37 & #42)



STEP 3. ATTACH CENTER CONNECTING BARS #46 #47
#48 USING THE SUPPLIED HARDWARE

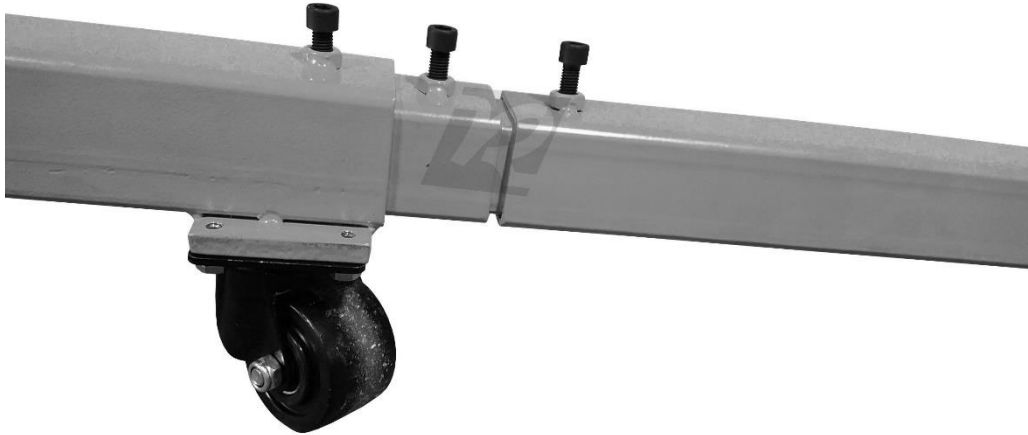

STEP 4. INSERT (#24) LIFTING STANDS INTO EACH SIDE
AS WELL AS #25 BOTTLE JACKS INTO EACH SIDE AND
CONNECT

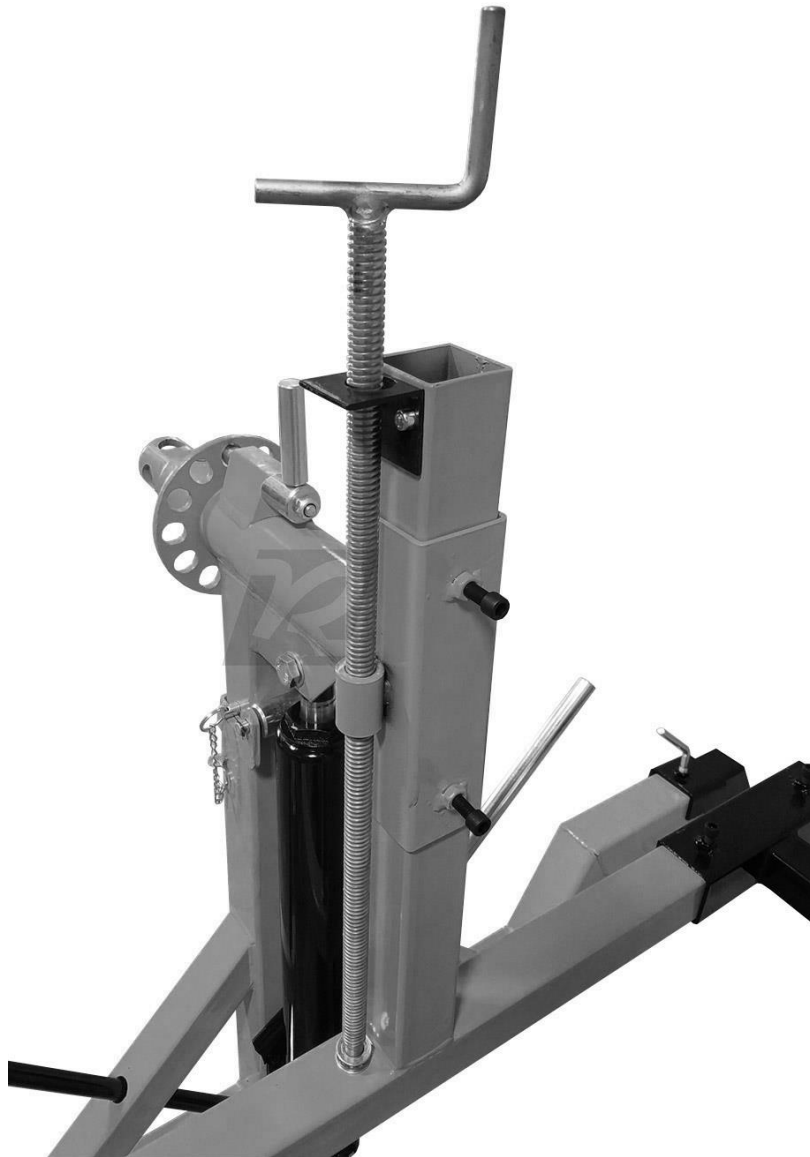

STEP 5. INSERT (#16) STAND INTO (#14) ROTATING
STAND ON BOTH ENDS BEING CAREFUL TO LINE UP
THE BOLT HOLES AND NOT CROSS THREAD THE BOLT

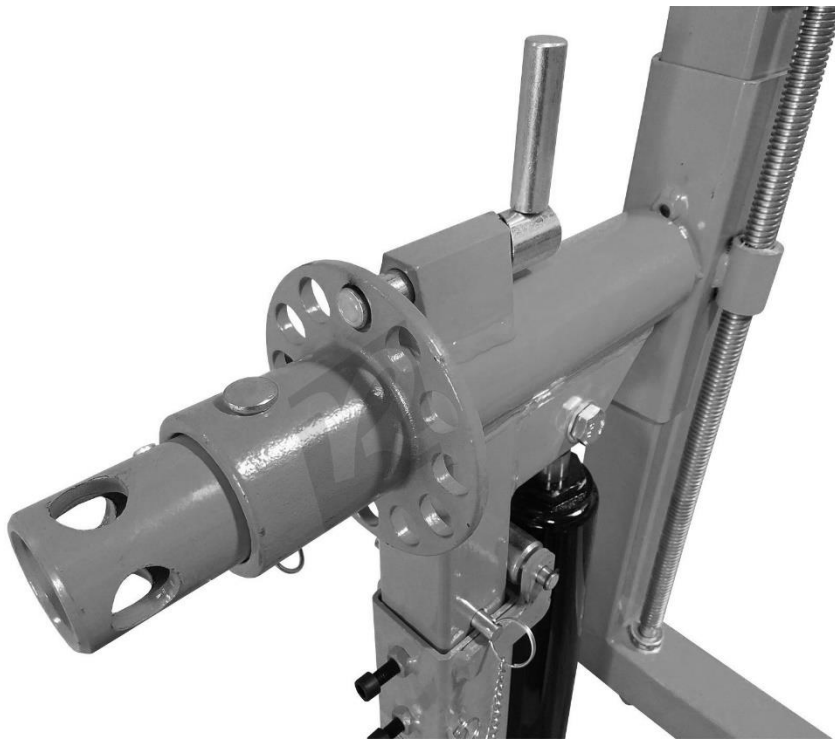

STEP 6. SLIDE ON ALL (#6) MOVEABLE STANDS ONTO #16 AND TIGHTEN DOWN SET SCREWS

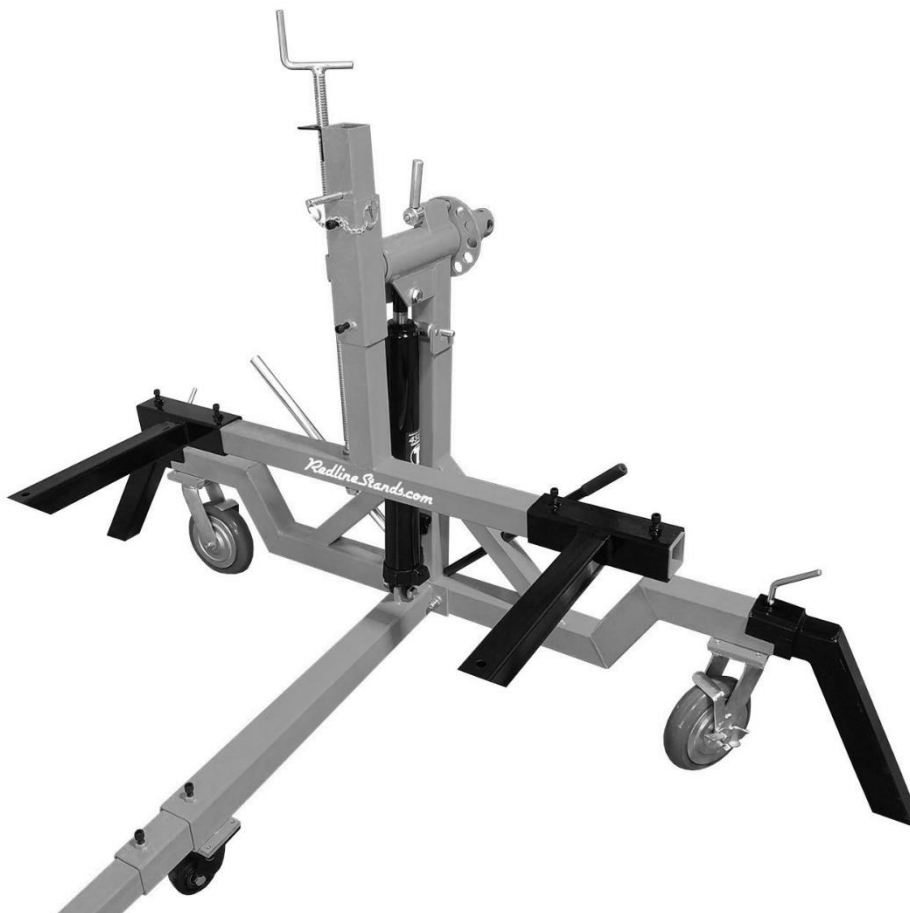

STEP 7. ATTACH #36 STEEL FEET TO #34 MAIN STAND
WITH SUPPLIED #35 SET SCREW FOR ADDED
STABILITY



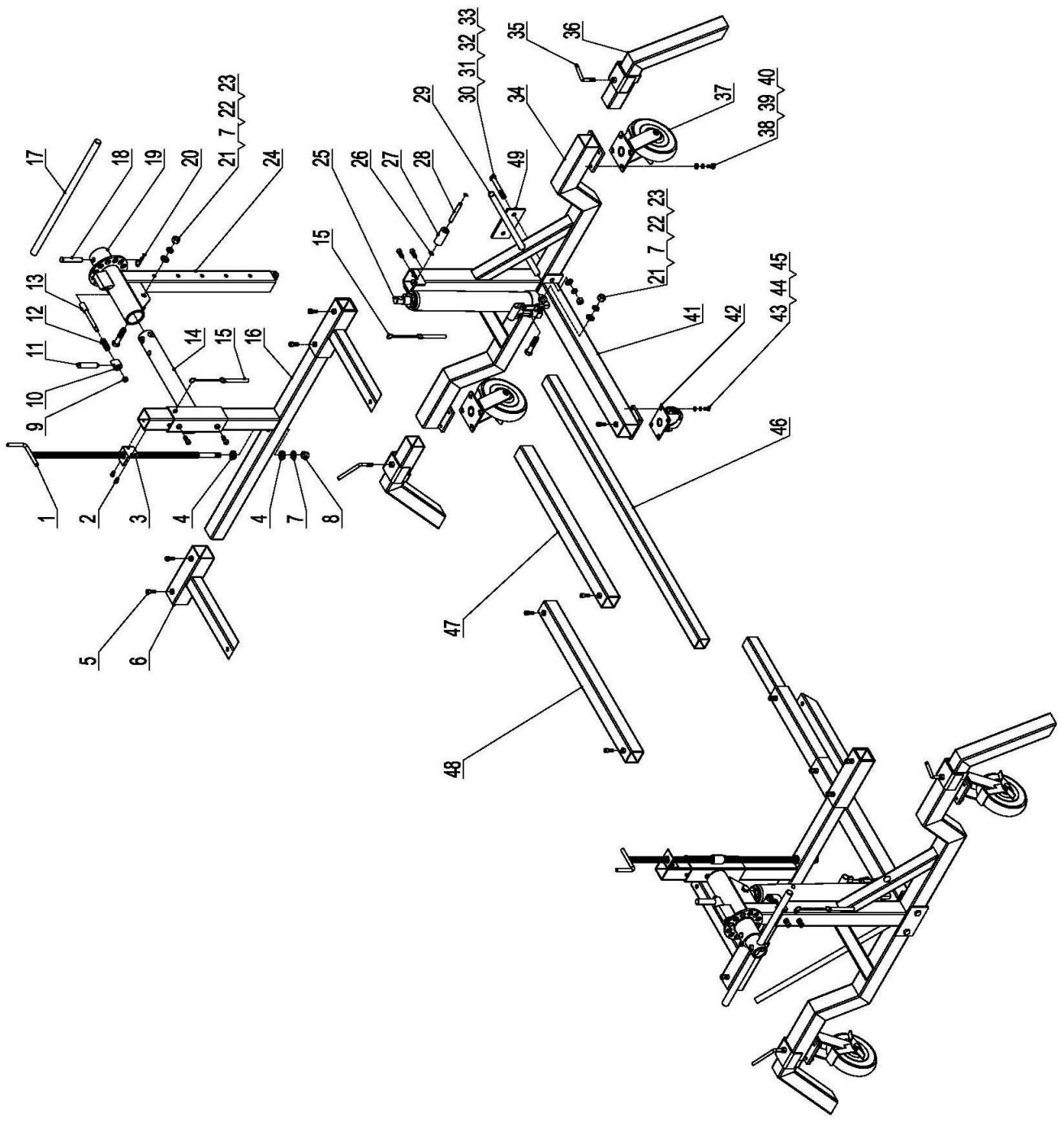

N0.	Description	QTY	N0.	Description	QTY
1	Adjust Screw Rod	2	26	Circlip	4
2	Screw M8*12	4	27	Guide Sleeve	2
3	Screw Rod Stand	2	28	Guide Spindle	2
4	Bearing	4	29	Operation Handle	2
5	Screw M10*25	22	30	Bolt M14*100	4
6	Movable Stand	4	31	Flat Washer Φ 14	4
7	Flat Washer Φ 16	6	32	Lock Washer Φ 14	4
8	Lock Nut M16	2	33	Lock Nut M14	4
9	Lock Nut M10	2	34	Main Stand	2
10	Wedge Handle Seat	2	35	Set Screw	4
11	Handle	2	36	Steel Feet	4
12	Spring	2	37	8" Caster	4
13	Locking Pin	2	38	Bolt M10*20	16
14	Rotating Stand	2	39	Lock Washer Φ 10	16
15	Chain Pin	4	40	Flat Washer Φ 10	16
16	Stand	2	41	Main Connecting Rod	2
17	Turning Handle	2	42	3" Caster	2
18	Connecting Pin	2	43	Bolt M8*16	8
19	Locking Plate	2	44	Lock Washer Φ 8	8
20	R-pin	2	45	Flat Washer Φ 8	8
21	Bolt M16*70	4	46	Extending Rod	2
22	Lock Washer Φ 16	4	47	Connecting Rod	2
23	Nut M16	4	48	Intermediate Connecting Rod	1
24	Lifting Stand	2	49	Plate	2
25	Hydraulic Cylinder	2			